

WELSH SCHOOL OF ARCHITECTURE

Diploma:
Professional Practice



We hope that the diversity and richness of the WSA experience is reflected in the illustrations in this brochure and we would like to thank and acknowledge the very wide range of contributors for providing the pictures.

Telephone: +44 (0)29 2087 4430
Email: archi-reception@cardiff.ac.uk
www.cardiff.ac.uk/architecture

[linkedin.com/school/welsh-school-of-architecture-cardiff-university](https://www.linkedin.com/school/welsh-school-of-architecture-cardiff-university)
twitter.com/WSofArchi
[facebook.com/welshschoolofarchitecture](https://www.facebook.com/welshschoolofarchitecture)
[instagram.com/WSofArchi](https://www.instagram.com/WSofArchi)

2022 Copyright



Contents

Introduction	4
Who is this programme for?	5
Teaching Methods	5
Modules	6
Prize Winners	7
Programme Director	8
Programme Staff	8

Postgraduate Diploma in Architecture: Professional Practice (Part 3)

Diploma Professional Practice (DPP) - acquire an in-depth understanding of the legal and economic aspects of architectural practice and construction procurement along with the related architectural profession.

“The DPP at the WSA has given me the confidence to practice as an Architect. Now I have the knowledge of legal, procedural, and management matters relating to the practice of Architecture. It has certainly informed my day-to-day practice already! The blend of teaching methods including online seminars and workshops, face-to-face lectures, guest speakers, and weekly blog posts made the course engaging and kept us informed of current developments in the industry.”

HELEN FLYNN

The DPP is designed to be undertaken while in employment, and can be undertaken on a blended learning basis (see Teaching Methods).

The Diploma has an outstanding reputation. This is reflected in the commendations it has received from three successive RIBA Visiting Boards including from the latest, in July 2021, when it was commended for ‘its synthesis of academic rigour and practice’. It is a highly quality learning experience, with small cohorts, tutored by a team of experts, including the course director. The programme is directed by Professor Sarah Lupton, who is well known for her expertise in this field, having published many books used widely by construction and design professionals, and on post-graduate courses.

It aims to inspire a keen interest in current issues relating to the profession, and to develop a high degree of analytic rigour and an in-depth understanding of the subject. These skills are developed through extensive group work and a variety of carefully developed assignments, with detailed individual feedback and interim stages.

Key features are the emphasis on workshop sessions (made possible through having a small cohort), the wide range of visiting speakers and topics covered, and the general thoroughness and care given to supporting the individual student. The feedback from the students has been very positive, as has that from external examiners. The Diploma is approved by the ARB and RIBA (Part 3), thus providing a route to registration as an architect in the UK.

Students who complete the course are encouraged to consider continuing their studies by enrolling on the Master of Design Administration, for which they would normally be given accredited prior learning for three modules shared with the DPP.

Who is the programme for?

The programme is suitable for those in full-time employment within an architectural practice or related construction industry organisation. It is intended for those who wish to qualify and register as an architect within the UK. Candidates who are not intending to become registered architects, or who are already registered, are advised to consider the Master of Design Administration programme. Applicants for the DPP should normally have qualifications prescribed by the Architects Registration Board (ARB) at Part 1 and Part 2, plus a minimum of 12 months professional experience compliant with ARB requirements. Occasionally we may waive these criteria in cases where candidates are in the process of having non-compliant qualifications approved by ARB and/or are sitting the ARB Prescribed Examination.

Teaching Methods

The DPP is offered on a full-time or part-time basis, both of which are designed to be undertaken whilst in full-time employment. The full time (fast track) route takes eight months, whereas the part time route takes two years (20 months).

The programme is delivered using a wide range of innovative teaching methods. There will be a series of single and two day teaching events, plus regular lunch-time webinars, online workshops given by leading experts, and a weekly blog updating you on course events and current industry developments relevant to the course.

Around 4-6 of the day events are planned to be on campus. These will be live streamed for those on the distance learning route. You will also receive regular written feedback on your work, and individual and group on-line tutorials. Supporting material will be available in the form of detailed course notes and pre-recorded video presentations.

A key feature of the DPP is the small size of the cohort, which enables extensive use of interactive workshops and master classes, group working and peer review. The programme uses a variety of assessment methods such as feasibility studies, reports and case studies, but without any class tests.

The DPP is delivered by a team of invited expert academics and professionals. The Programme Director takes a very hands-on approach, and is closely involved in the organisation of the course, and with teaching, for example most of the individual tutorials will be with the course leader.

“What makes the Cardiff postgraduate diploma course unique is the rigour with which it is approached. We are given the opportunity to learn about a huge range of matters that relate to the professional practice of architecture that often go above and beyond the basic requirements of the qualification.”

TOM WOODWARD

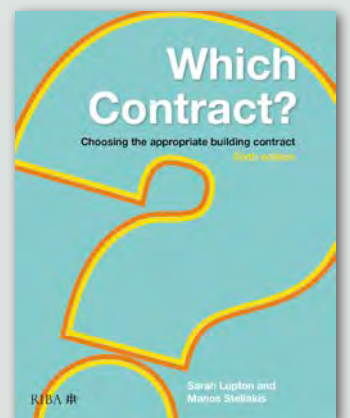
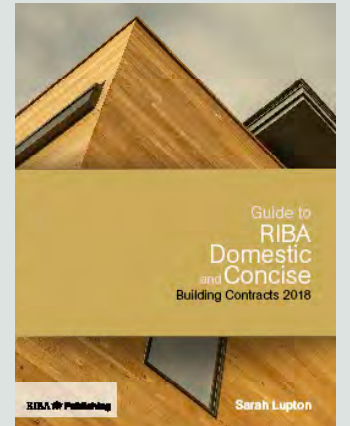

Modules

Industry context

Enables the student to develop a critical understanding of the context for the design of building projects within the UK, including factors which control the UK construction industry and the procurement and management of professional services and construction projects. It explores the key constraints and enablers for development projects, in particular those that would affect their design, including government policy, legislative instruments such as planning law and building control, and related guidance. It also examines incentives such as funding strategy and fiscal measures. A key focus in the examination of the context is the role of designers and design in the construction industry. The module provides the student with the knowledge and skill necessary to advise a client on the feasibility of a development proposal.

Construction contracts

Examines in detail the more commonly used standard forms of construction contract, including traditional and design-build forms appropriate for small and large projects. It considers methods for their administration, including where the design is provided by consultants, specialists, or contractors, or by a mixture of these. It will discuss problems that frequently occur and the causes and resolution of contractual claims, focussing throughout on issues related to design, quality management, and the management of risk.

Professional services

Examines issues relating to providing professional services, in particular design services, and to managing the provision of design services in relation to both large and small projects. It explores the role of the various construction professions, the means of assessing and agreeing terms of engagement for a building project, and outlines how the services may be integrated as part of a multi-disciplinary procurement team. The module covers traditional and cutting edge business models for both small and large firms. The module also examines the marketing, planning, and resourcing of professional services, employment and staff-related issues, and the management of firms providing professional services.

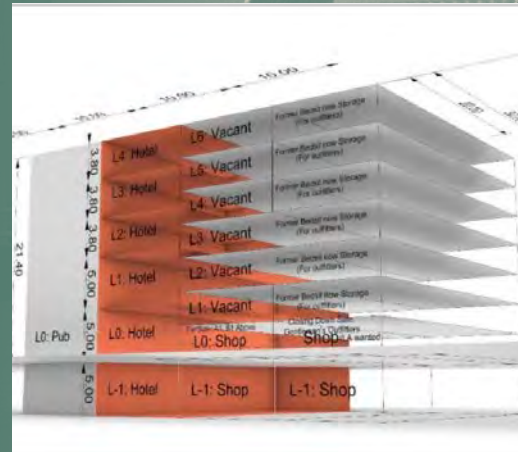
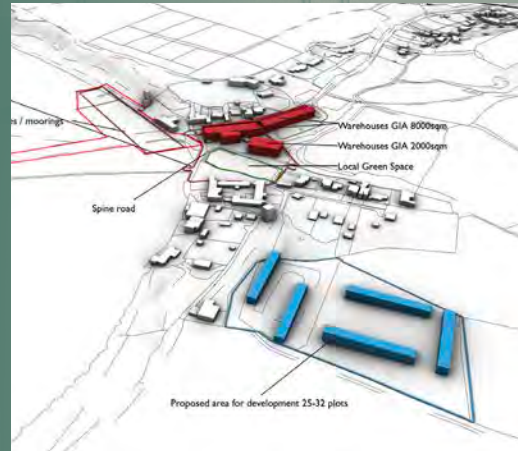

Professional Practice

Examines the role of the architectural professional, including its regulation and governing institutions, and related concepts of professionalism and professional ethics. It introduces the student to the range of architectural services that the professional offers, and the means of assessing and agreeing terms of engagement for a building project. It explores methods of management of architectural practices of various sizes and forms, including the management of their financial and human resources, and the legislation related to this. The module will enable the student to acquire the knowledge and skills necessary to manage a small architectural practice, and contribute to the management of larger architectural practice. It also explores methods of project planning, project management and the quality control of construction projects of various sizes and forms from inception through to the occupation, in particular the role of the architect in managing or contributing to the project team. The knowledge and skills acquired enable the student to contribute to the work of a multi-disciplinary team in managing a larger project.



Prizes

A prize is awarded by **Stride Treglown** for the best Diploma graduate, and by the **Society of Construction Law** for the **best performance in Construction Contract Law**. The prize-winners over the last few years have been as follows:

2016	Emily Partridge and Choe Sheward	Guylee Simmonds
2017	Stephanie Adamou	Azhar Kapadi
2018	Jenny Saunders	Edmund Browne
2019	Blanca Dumea	Timothy Smith
2020	Ross Hartland and Danielle Simpson	Ross Hartland
2021	Danielle Tucker and Adam Yapp	Samantha Litherland
2022	Helen Flynn	Haya Magdy Mohamed

Programme Director

This programme is led by Professor Sarah Lupton, who holds a personal chair at the Welsh School of Architecture and is a partner in Lupton Stellakis architects. She is dual qualified as an architect and as a lawyer. She lectures widely on subjects relating to construction law and is the author of many books, including ‘*Design Liability in the Construction Industry*’, a series on standard form building contracts, and is co-author (with Manos Stellakis, who also teaches on the course) of ‘*Which Contract?*’, of a series of books on the use of performance specification, and of a series on legislative controls. She contributes regularly to the International Construction Law Review, and acts as an adjudicator and expert witness in construction disputes. She is Chairman of the CIC Liability Panel and a member of the RIBA Professional Services Contracts Editorial Group.

Programme Staff

Professor Sarah Lupton
MA, Dip Arch, LLM, FCI Arb, C Arb, RIBA
(Programme Director)

Manos Stellakis
BSc, DipArch, MSc (Econ) RIBA,
(Partner, Lupton Stellakis architects;
Expert Consultant, WSA)

Programme Contacts

Professor Sarah Lupton (Programme Director)
Email: lupton@cardiff.ac.uk
Tel: +44 (0)29 2087 5966

Architecture Admissions
Email: ArchitectureAdmissions@cardiff.ac.uk
Tel: +44 (0)29 2087 4430

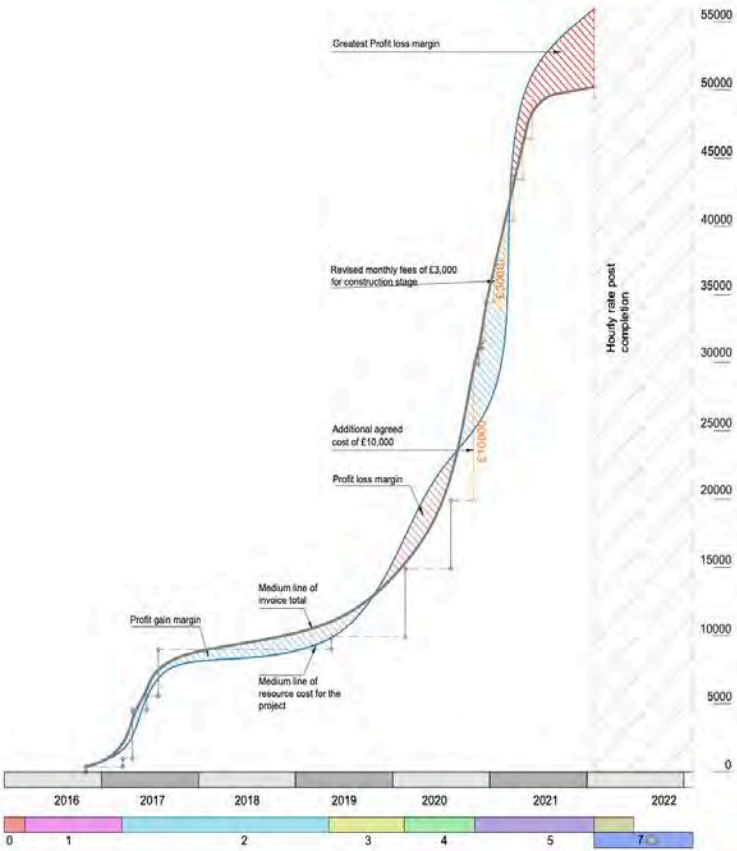
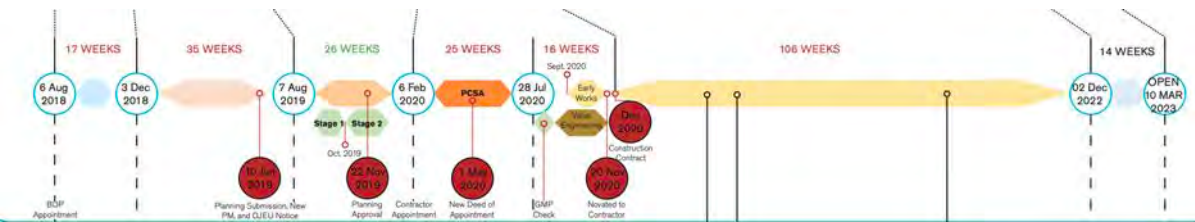
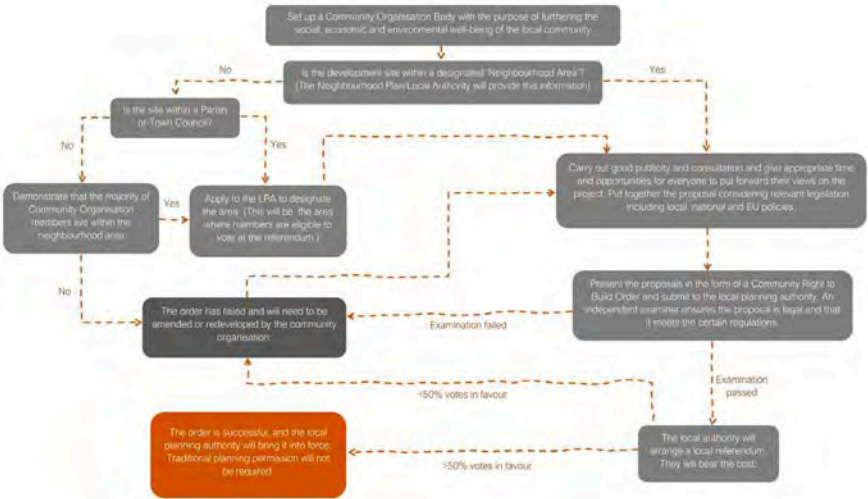

1/2 Partial 1 Developed

PC	1	2	3	4	5
1					
2					
3					
4					
5					
6					
7					
8					
9					
10					

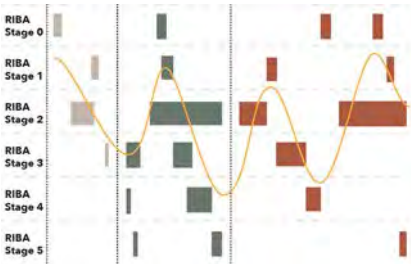



Welsh School of Architecture
Cardiff University
Bute Building
King Edward VII Avenue
Cardiff CF10 3NB
United Kingdom