



'Don't start from the good old things but the bad new ones.' Berthold Brecht

As cities expand and grow, allocation of **industry** gets placed further to the periphery of cities. Whether in the form of 'warehouse lots' or 'industrial parks', these places become segregated and contained with little or no connection to the city. Taking this as a contemporary condition, the studio will investigate the importance of these spaces to cities, in activating street life, relationships to infrastructure and buildings by providing generosity to those working and living within.

Investigation will be focused on **ensembles**. Industrial use quite often requires as much exterior space as interior with vehicle servicing and parking thereby giving importance to the space between structures. Strong emphasis of the studio will be placed on the **composition** of these spaces in relation to buildings, infrastructure and landscape.

INDUSTRY ENSEMBLE

Initially, **ideas of composition** will look at modern abstract painting from Morandi's still lifes, Brice Marden's ink paintings, de Stael's abstract landscapes, to Rothko's early scene paintings with emphasis on the space between 'things'. This will lead to a **spatial mapping study** by testing the conditions of an existing workshop, car garage, or small industrial unit in Cardiff. Concurrently, precedent projects / designs will be studied.

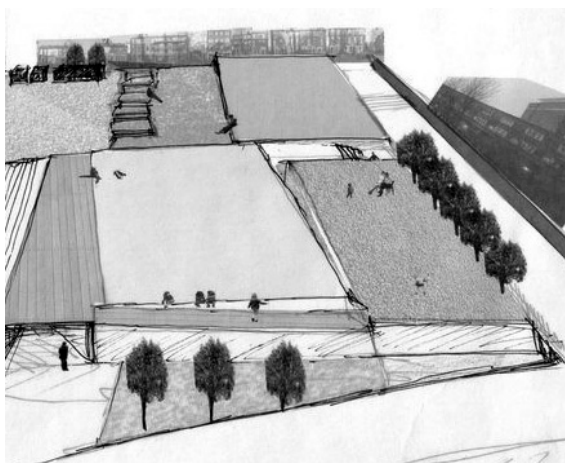

The project is to **design an ensemble**; a small workshop building, a cafe and an outdoor leisure space. The context will be along the stretch of Penarth Road beyond Sloper Road to the junction with the Ely River. The area forms a series of light and heavy industry with very little amenity spaces for employees and inhabitants.

The modes of investigation throughout the term will be **drawings and physical models**. With existing buildings, car parks and infrastructure, the task is to invoke a **positive intervention with strong urban connections** to the current form of unconsidered industry space.